

# Product Range

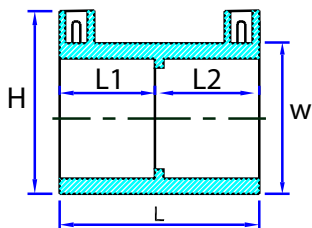

## Couplers

Nominal diameter mm	Pack qty	Dimensions mm					Max weight kg	Fuse time sec	Cool time min	Product code 40 V 4.0 mm pin
		H	L	L1	L2	W				
63	1	98	105	52	52	77	0.16	28	5	WB8258
90	1	131	125	62	62	109	0.39	90	10	WB8260
125	1	168	157	77	77	151	0.88	120	15	WB8262
180	1	229	207	102	102	215	2.25	220	12	WB8265
250	1	315	219	109	105	296	4.26	600	37	WB8273
315	1	387	266	133	129	380	8.6	850	33	WB8279



## Easigrip® couplers - 80 V

Nominal diameter mm	Pack qty	Dimensions mm					Max weight kg	Warm-up time sec	Soak time sec	Fuse time sec	Cool time min	Product code 80 V 4.0 mm pin
		H	L	L1	L2	W						
355	1	415	319	158	158	407	9.2	-	-	700	35	WA0331
400	1	465	340	169	169	456	12.3	-	-	800	44	WA0333
450 <sup>1</sup>	1	526	376	187	187	517	17	180	600	700	45	WA0335
500 <sup>1</sup>	1	581	374	186	186	574	21.5	180	600	800	55	WA0337

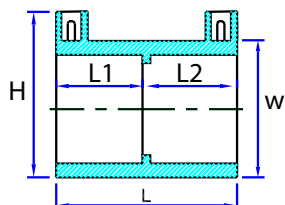

### Note:

- 1- Couplers use a 3-part 80 V electrofusion process. Compatible equipment must be used to weld the Easigrip® couplers. Please refer to the Easigrip® instruction details within this brochure.



## Equal tees - spigot off-take

Nominal diameter mm	Pack qty	Dimensions mm							Max weight kg	Fuse time sec	Cool time min	Product code 40 V 4.0 mm pin
		H	L	L1	L2	ØS	SL	W				
63	1	98	158	54	54	63	70	159	0.34	50	6	WB2208
90	1	131	200	63	63	90	85	206	0.83	90	9	WB2210
125	1	169	247	73	73	125	95	256	1.89	120	10	WB2212
180	1	240	362	106	106	180	130	371	6.21	280	19	WB2215

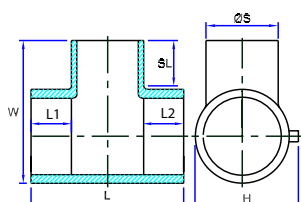

Always refer to the fitting and packaging label for the most up to date information.