

# Product Range



## PurgeTee™

PurgeTee™ is Radius Systems' patented innovative solution to carry out all mains purging, pressure testing and bypass construction operations. Our PurgeTee™ brings additional benefits to gas operators and installers offering a more compact solution with reduced spigot length and height, delivering a reduced installation footprint.

Manufactured with a unique injection moulded elbow, fused in a factory controlled environment, our PurgeTee™ offers a fully welded solution which reduces the number of site made electrofusion joints for optimum system integrity. Quick and easy to install compared to alternative solutions, PurgeTee™ is designed with a Unifit® base to suit a range of pipe diameters and SDRs and is manufactured from high performance PE100.

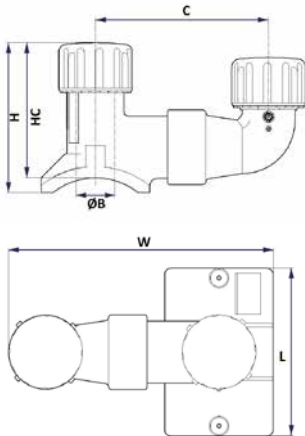

## PurgeTee™ - 32 mm outlet

Nominal diameter mm	Pack qty	Dimensions mm						Max weight kg	Fuse time sec	Cool time min	Product code 40 V 4.0 mm pin
		ØB	H	HC	C	L	W				
40 <sup>5</sup>	5	20	182	133	114	115	176	0.45	40	4	WA8333
55	5	20	148	116	114	115	174	0.45	55	4	WA8335
63 & 2"	5	20	153	122	114	115	179	0.45	55	4	WA8336
75	5	20	140	123	114	115	178	0.45	55	4	WA8337
90 & 3"	5	20	142	123	114	115	185	0.45	55	4	WA8338
110 - 140 & 4"	5	20	140	127	114	115	182	0.45	55	4	WA8341
140 - 180 & 6"	5	20	138	127	114	115	185	0.45	55	4	WA8342
200 - 250 & 8" <sup>6</sup>	5	20	134	127	114	115	185	0.52	55	4	WA8351
268 - 355 <sup>6</sup>	5	20	132	127	114	115	185	0.52	55	4	WA8359
400 - 560 <sup>6,7,8</sup>	5	20	130	127	114	115	185	0.52	60	4	WA8367

## PurgeTee™ - 63 mm outlet

Nominal diameter mm	Pack qty	Dimensions mm						Max weight kg	Fuse time sec	Cool time min	Product code 40 V 4.0 mm pin
		ØB	H	HC	C	L	W				
63 & 2"	3	34	171	135	176	170	252	1.27	55	4	WA8461
75	3	34	166	143	176	170	263	1.27	55	4	WA8462
90 & 3"	3	34	166	135	176	170	263	1.27	60	4	WA8463
110 - 125 & 4"	3	34	162	137	176	170	268	1.27	70	4	WA8466
140 - 155	3	34	152	137	176	170	268	1.27	70	4	WA8467
155 - 180 & 6"	3	34	152	135	176	170	268	1.27	70	4	WA8469
200 <sup>6</sup>	3	34	146	135	176	170	268	1.51	70	4	WA8472
213 - 280 & 8" <sup>6</sup>	3	34	146	135	176	170	268	1.51	75	5	WA8474
315 - 355 <sup>6</sup>	3	34	144	135	176	170	268	1.51	80	4	WA8482
400 - 469 <sup>6,8</sup>	3	34	142	135	176	170	268	1.51	75	4	WA8486
500 - 560 <sup>6,8</sup>	3	34	139	135	176	170	268	1.51	80	5	WA8492

### Note:

- 5 - Fitted with an under-part
- 6 - Fitted with a thread follower which must be removed after tapping the main.
- See guidance within this brochure
- 7 - Not suitable for use with 560 mm SDR17 and SDR17.6 pipe
- 8 - Not suitable for use with SDR11 pipe
- ØB = cut hole diameter

For pipe connections identified in footnotes 7 and 8, please contact Radius Subterra our live pipeline engineering division on t: 01773 582317 or e: radius.subterra@radius-systems.com.

For the MOP of tapping tee products for gas applications, please refer to the packaging label or contact Radius Systems.

For instructions on how to install our saddle fittings, please refer to the jointing guidance within this brochure.

# Product Range



## PurgeTee™ accessories & tooling (sold separately)

A reusable 1" (32mm) or 2" (63mm) adaptor is required to fit on the PurgeTee™ outlet, to facilitate pressure test or purge tooling connections.

The PurgeTee™ adaptor converts the PurgeTee™ moulded outlet thread to a BSP F thread, suitable for metallic purge stack connections.

Description	Product code
32 mm x 1" BSP-F adaptor	FT0655
63 mm x 2" BSP-F adaptor	FT0656
Short T key	FT0657

